

DESIGN DRAWINGS

Terminal type 2 (Copper windings)

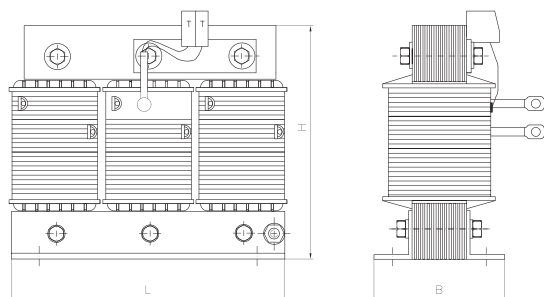

Terminal type 2 (Aluminium windings)

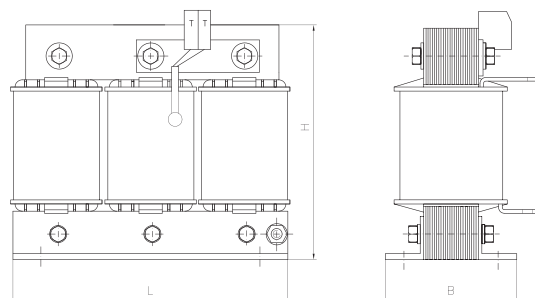

TECHNICAL DATA

Standards	EN 61558-2-20:2000, VDE 0570-2
tolerance of inductance	±3%
<small>(mean value across three phases)</small>	
linearity	$I_{lin} = 1.4 \times I_N$
insulation (winding-to-core)	3 kV
insulation class	B
protection class	IP00 indoor mounting

temperature class	T40
humidity	95%
cooling	natural cooling
altitude abv.s.l.	4000m
design	3 phase, iron core multiple air gap
winding material	Copper/Aluminium
impregnation	Polyester resin, class F

I_N (A/phase)	type designation	L_N (mH/phase)	W_N (Ws)	winding	terminal type	optional terminals	weight (kg)	L × W × H (mm)	order code
2% U_K U_N 400V 50Hz 3phase									
55	ELR 55/400/50/2/Cu	0.267	0.4	Cu	2	1. 3	5.5	155 × 92 × 140	40N.074-271055/001
80	ELR 80/400/50/2/Cu	0.184	0.59	Cu	2	1. 3	8	190 × 92 × 165	40N.094-181080/001
120	ELR 120/400/50/2/Cu	0.123	0.88	Cu	2	1. 3	11.9	190 × 126 × 165	40N.097-121120/001
160	ELR 160/400/50/2/Cu	0.0919	1.18	Alu	2	3	13.7	240 × 131 × 215	40N.125+920160/001
200	ELR 200/400/50/2/Cu	0.0735	1.47	Alu	2	3	18.6	240 × 155 × 215	40N.327+740200/001
250	ELR 250/400/50/2/Cu	0.0588	1.84	Alu	2	3	25	300 × 165 × 265	40N.156+590250/001
300	ELR 300/400/50/2/Cu	0.049	2.21	Alu	2	3	39	300 × 203 × 265	40N.160+490300/001
4% U_K U_N 400V 50Hz 3phase									
30	ELR 30/400/50/4/Cu	0.98	0.44	Cu	2	1.3	5.5	155 × 92 × 140	40N.074-981030/001
55	ELR 55/400/50/4/Cu	0.535	0.81	Cu	2	1.3	9.4	190 × 92 × 165	40N.094-541055/001
80	ELR 80/400/50/4/Cu	0.368	1.18	Cu	2	1.3	12.9	190 × 126 × 165	40N.097-371080/001
100	ELR 100/400/50/4/Cu	0.294	1.47	Alu	2	3	14.7	240 × 131 × 215	40N.125+291100/001
160	ELR 160/400/50/4/Cu	0.184	2.35	Alu	2	3	21	240 × 155 × 215	40N.327+181160/001
200	ELR 200/400/50/4/Cu	0.147	2.94	Alu	2	3	27.9	300 × 165 × 265	40N.156+151200/001
250	ELR 250/400/50/4/Cu	0.118	3.68	Alu	2	3	40.4	300 × 203 × 265	40N.160+121250/001
300	ELR 300/400/50/4/Cu	0.098	4.41	Alu	2	3	63.3	420 × 188 × 370	40N.218+980300/001

ELECTRONICON®

Germany · 07549 Gera · Keplerstrasse 2
 Fon +49 365 / 734 61 00 · Fax +49 365 / 734 61 10
 E-Mail: sales@electronicon.com, www.electronicon.com

